

Option 1

Option 2

Option 3

Door Style: _____
 Species: _____
 Color: _____
 Construction: _____
 Options: _____

Door Style: _____
 Species: _____
 Color: _____
 Construction: _____
 Options: _____

Door Style: _____
 Species: _____
 Color: _____
 Construction: _____
 Options: _____

Estimated Budget: \$ _____

Estimated Budget: \$ _____

Estimated Budget: \$ _____

Sample 10'x10' Kitchen

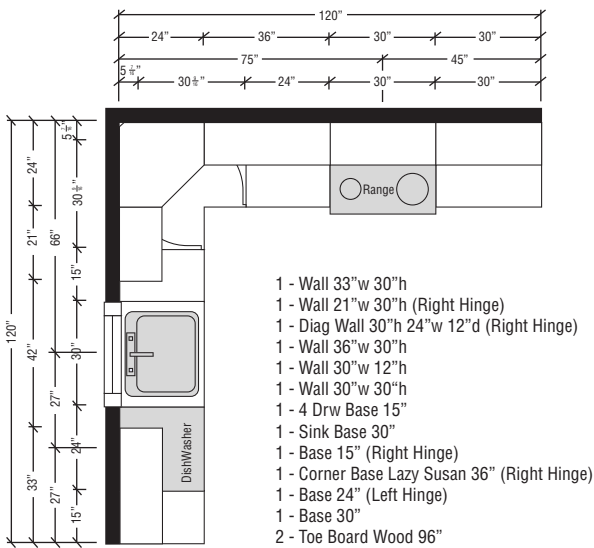

Below is a sample 10' x 10' Kitchen. We have put together a standard kitchen to help you see how the different levels within the Homecrest Cabinet line compare. We have included the cabinets within the design, a layout, and 3D rendering to help describe what is included in the price ranges we provide.

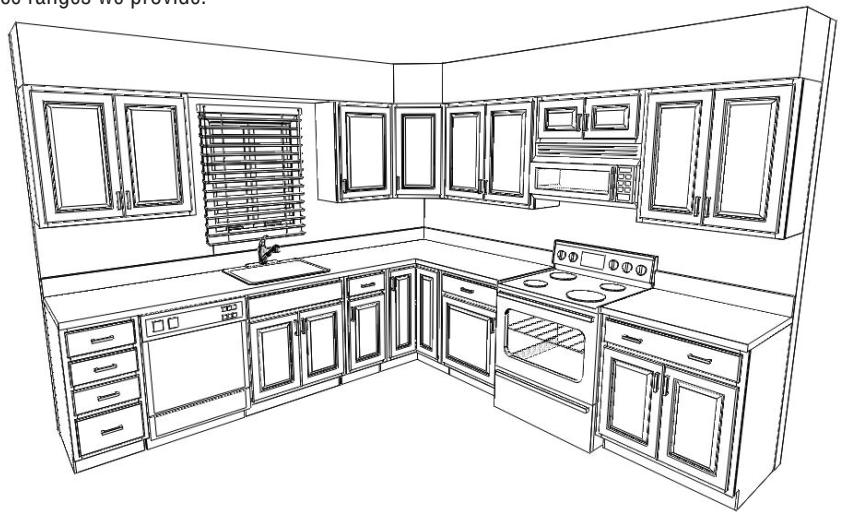

\$

\$\$

\$\$\$

\$\$\$\$

\$\$\$\$\$

Approximately
\$2500-2800

Approximately
\$2800-3400

Approximately
\$3200-3800

Approximately
\$3700-4500

Approximately
\$4500+

*The above price ranges are for reference only. Actual prices may vary depending on specific sizes, dimensions, and accessories included in your specific layout/design. Please consult our kitchen design staff to determine a more precise quote for your kitchen cabinets.



Designers: Kristi - kristi@woodfloorsplus.com
 Michelle - michelle@woodfloorsplus.com

50 Orchard Rd Glen Burnie MD 21060
 Phone: 410-636-9663 | Fax: 410-636-1895
WWW.WOODFLOORSPLUS.COM

Customer Information

Name: _____
 Phone Number: _____
 Fax Number: _____
 Email: _____

Cabinet Measuring Guide

0	2	4	6	8	10	12	14	16	18	20	22	24	26
0													
2													
4													
6													
8													
10													
12													
14													
16													
18													
20													

Appliance Information

	Type	Size W x D x H	Hinge Position <small>L/R(FACING APPLIANCE)</small>
Refrigerator			
Range			
Cooktop			
Exhaust Hood			
Wall Oven			
Microwave			
Dishwasher			
Sink			
Other			

Customer Information

Name: _____
 Phone Number: _____
 Fax Number: _____
 Email: _____

Measuring Procedure

Horizontal Measurements

1. Measure from wall to wall at 36" height.
2. Measure from corner to window or door opening.
3. Measure across opening from trim edge to trim edge.
4. Measure from edge of trim to far wall. Compare sum of #2, #3 and #4 measurements to step #1.
5. Mark exact location of water, drain, gas lines and electrical outlets and switches on drawing.
6. Measure from wall to wall above window and compare to #1.

Vertical Measurements

7. Measure from floor to window sill.
8. Measure from window sill to top of window.
9. Measure from top of window to ceiling.
10. Measure from floor to ceiling-compare to sum of #7, #8 and #9.



50 Orchard Rd Glen Burnie MD 21060
 Phone: 410-636-9663 | Fax: 410-636-1895
WWW.WOODFLOORSPLUS.COM